



ONCE-IN-A-GENERATION INFRASTRUCTURE PROJECT

CLIENT : University of Melbourne
MAIN CONSTRUCTION COMPANY : Kane Constructions
CONSTRUCTION VALUE : \$168 million
TYPE : Education

The University of Melbourne Student Precinct is a world-class student hub with both new and refurbished buildings that includes a new Arts & Cultural Building, ERC Library, Student Pavilion, building refurbishments and more.

In December 2019, Kane Constructions was awarded the Design & Construct contract to deliver the University of Melbourne Student Precinct. The precinct includes six buildings and will deliver 37,050m² of new or refurbished internal and external buildings and landscape space.

The scope of work included a new Arts and Cultural Building which includes a state-of-the-art theatre, the refurbishment of the ERC Library, Building 168, Building 189, and the 1888 Building. Kane Constructions also completed landscaping for Amphitheatre North, and the refurbishment of Amphitheatre South, which when complete will deliver a world-class student hub.

The project makes a significant contribution to the transformation of the on campus student experience at Parkville by co-locating student services and activities closer to the new heart of the campus, and to primary transport links.

“This has been an amazing project,” said Kane Constructions Project Manager, Jason Malmur. “The buildings are all unique within the precinct and together they really stand out, which is something the University of Melbourne was keen to see come to life.”

“Kane’s brief was the design and construct of the entire precinct which meant there was not a single set of consultants but rather a different set of architects and trades for each building,” explained Jason.

“We were dealing with the mix of refurbishments and new buildings, the varying stages of demo, in ground contamination of the soil, the heritage aspects of buildings – including internal aspects, as well as the façades – not to mention the heritage listed trees.”

The site itself is complex and constrained, and traffic across the precinct is complicated by a 6m level drop north to south.

Kane was responsible for managing the multitude of consultants, trades and subcontractors across one timeline. As project managers they also had to ensure consistency in terms of the university requirements in all the builds, despite their differences.

“The whole team really came together to navigate through this process. The Kane family, including the delivery teams in each building, maintained such a high level of motivation and drive from 2020 when we commenced onsite, throughout COVID and right through to the completion of each building,” said Jason. “It’s fantastic that each building in the precinct has been really well received by both the University and the students.”

Kane Constructions is a multi-award winning, privately owned commercial construction company active in all sectors of the industry. Kane Constructions commenced operations in Melbourne in 1973, and the company operates throughout the east coast of Australia from offices in Melbourne, Sydney, Brisbane, Sunshine Coast and Canberra.

Kane Constructions was awarded the 2016 and 2019 National Construction Master Builder of the Year by Master Builders Australia

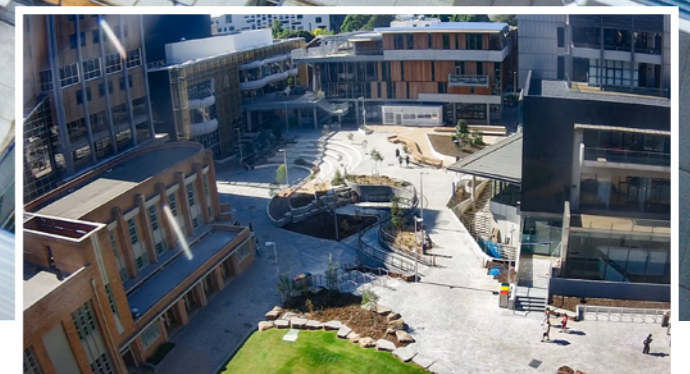

and the Master Builder of the Year in Victoria for 2016, 2017, and 2019 by the Master Builders Association of Victoria.

For more information contact Kane Constructions, Level 9, 510 Church Street, Cremorne VIC 3121 phone 03 8420 1200, email viccontact@kane.com.au, website www.kane.com.au

FROM OLD TO NEW: SPECIALISED SOLUTIONS FOR STRIPING OUT AND DEMOLITION WORKS

Mann Vic have proven to be a reputable and sought out provider for demolition services across Australia and were the obvious choice for the Tier 1 Demolition and HAZMAT removal at the Student Precinct at the University of Melbourne.

Their scope of works included full demolition of the Alice Hoy Building; the complete refurbishment and atrium removal of the Eastern Resource Building; multiple floor refurbishments in the Doug McDonnell Building; extensive and articulate heritage salvage with new openings created in heritage three foot thick walls in both the 1888 Building and the Frank Tate Building.

“There were multiple challenges working around buildings that were live and had members of the public in the vicinity,” said Mann Vic’s National Operations Manager, Khaled Awad. “There were also many heritage restraints that required innovative and critical thinking concepts to ensure there was no damage to the heritage aspects of each item and building.”

Renovation or refurbishment of a building often requires specialised strip out services. Mann Vic have the experience to ensure safety, efficiency and maintenance of structural integrity. Strip-out services include interior building strip-outs, removal of fittings and fixtures, removal of walls and partitions, window removal, insulation, grid and ceiling removal, concrete floor removal and masonry walls. Materials are salvaged, reused or recycled wherever possible, the site reaching an extraordinary 97.2% recycle rate.

“For this project each building required its own unique and custom demolition sequence,” said Khaled. “With client consultation, thorough planning and attention to the job requirements, we developed project specific demolition methodologies which were executed by our expert demolition team.”

Along with the heritage salvage and restoration, Mann Vic also provided high end needle propping, structural underpinning, Friable and Bonded Asbestos removal, suspended slab back propping designs for 50 tonne excavators, sequenced crane lift plans for the removal of a custom steel truss atrium and precast panel sections over 22 tonne each.

The project was also taking place during the height of COVID Restrictions, Mann was able to implement and follow all guidelines without affecting the project’s safety and programme.

Mann Vic has extensive experience in heritage conservation projects and façade retention. This includes design and construct engineering, installation of temporary/permanent structures, unique and pioneering demolition sequences as showcased at the Iconic Malt District, Nylex Clock Silo’s – where Mann Vic took out best in their field in the International World Demolition Awards.

Mann Vic’s mission is to fulfill its vision by fostering innovation, education and relationships to invigorate and revolutionise the demolition industry, totally committed to continual improvement through the execution and delivery of their interactive application technology, safety, and environmental and quality management

systems ensuring projects are delivered professionally.

“We bring a fresh approach and collaborate closely with our clients to ensure each project is delivered safely, professionally, within time frames and on budget,” said Khaled.

Mann Vic is able to provide Demolition Consultation Services to clients during the scoping phase of decommission or demolition projects. Working with an experienced demolition team from the beginning ensures that project planning and risk analysis are expertly considered every step of the way.

With the essential expertise, systems and equipment, Mann Vic successfully deliver on projects of all sizes and degrees of complexities. Mann Vic currently have over 23 active sites including the iconic Marvel Stadium, Metro Tunnels in Melbourne and Chadstone Shopping Centre one of the largest in the Southern Hemisphere and operate in all sectors of Demolition.



For more information contact Mann Vic, 4-10 Nantilla Road, Clayton VIC 3168, phone 1300 626 647, email admin@manngroup.com.au, website www.manngroup.com.au

- 📍 manngroupvic
- 📞 manngroupvic
- 🌐 manngroupvic



THERMAL EFFICIENCY AND FIRE PROTECTION

Passive Fire Protection and Thermal Insulation are a vital component of any building these days as they not only provide the fire protection but sustainability to the building by increasing its thermal efficiency contributing to the Reduction of the Energy Consumption hence less Carbon Footprint.

The Passive Fire Protection main purpose is to serve as a fire strategy to protect the Building Structure in case of Fire Scenario to allow for enough time for evacuation and for the Fire Suppression Systems to activate and avoid a structural collapse. PFS Group was the company selected to work alongside with Kane Constructions to supply and install the Passive Fire Protection and Thermal Insulation required for the University of Melbourne – Student Precinct Buildings.

PFS Group is an Australian Service Driven Company with over 25 years of experience providing Fire Rating Solutions, Thermal and Acoustic Innovations to all industry sectors including – Commercial, Industrial, Mechanical, Civil, Healthcare, Heritage Listed and Special Purpose Buildings.

With over 20 hi-tech spray machines and specialised equipment, highly skilled fully trained personnel in and out of the job sites and a remarkable customer service to meet all customer requirements and time constraints.

“Throughout the duration of the project PFS Group was confronted with challenges that involved innovated solutions to meet client’s requirements,” said PFS Group Senior Project Manager, Jose Fragachan.

Furthermore, PFS Group Construction Project Manager, Eduardo Capiello added; “Even though challenges were encounter throughout the project, PFS Group Personnel and Management Team worked hand-on-hand with our suppliers (Grace Australia, Knauf Insulation and Permax) and Kane Construction management team to keep the project running smoothly and within the timeframe, even during the difficult pandemic times. It was a pleasure to work alongside Kane Construction Management Team in this project and we look forward to continuing building our relationship with them.”

For more information contact PFS Group, 2/401 Francis Street, Brooklyn VIC 3012, phone 03 9318 9717, website www.pfsgroup.com.au

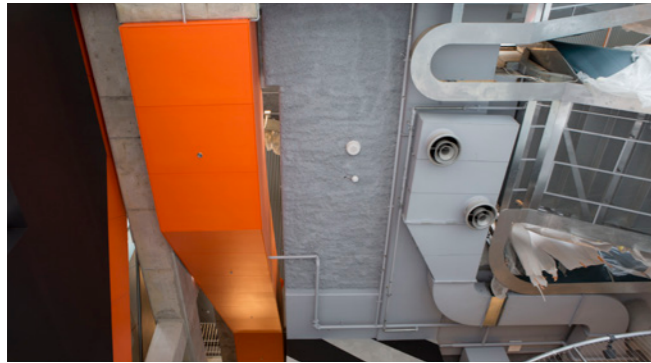

KEEPING KNOWLEDGE IN ORDER

Quantum Library Supplies create innovative spaces designed for today’s University, Public and School Libraries and have a long-term relationship with the University of Melbourne. For the fitout of the refurbished ERC Library, Quantum were contracted to design, deliver and install the return and sorter system including the electronic returns bins – a system they originally designed and installed over 20 years ago.

“We are always happy to work with builders and architects to ensure we get the design right,” said Sales Manager, Colin Matthews. “In this job we spotted an issue with one of the doors clipping a returns bin when it opened. Working the challenge through we were able to have the door moved so it no longer obstructed the system.”

Over 90% of Quantum’s products are manufactured in house at their Brisbane factory. Colin’s role is to visit project sites before the design is finalised and created in Brisbane. Local subcontractors install the product with the Quantum techs able to remote-view the install and provide tech support.

Quantum Library Supplies has been designing innovative libraries, manufacturing library furniture, shelving and book handling automation for libraries Australia wide since 1979 and is an Australian family-owned business with a staff of 21. With more than 40 years in business, Quantum has evolved with the market.

“We originally started working with plastics and shelving,” said Colin. “But we’ve grown to have our own joinery, steel and electronic

workshops. One of the benefits of being a company that specialises in custom manufacturing is that we can design great pieces of custom furniture.”

Quantum’s vision is to provide unique and custom solutions that are not only best of breed but also set the trend for innovation in Libraries and Schools, Australia Wide. Recent projects include full fitouts at Avalon Public School, Bilpin Public School Woodford and Strathpine Public Libraries, as well as the flood refurbishment of Lismore Public Library.

For more information contact Quantum Library Supplies, 1/135 Ingleson Road, Wakerley QLD 4154, phone 1800 773 374, website quantumlibraries.com.au

CREATIVE CUSTOM CERAMIC HANDLES

R L Foote Design Studio was founded by Installation Artist, Designer, Chef and Food Designer Ryan L Foote whose diverse background provides a unique source of technical know-how and creative innovation. The studio created the custom ceramic door handles for the entire Student Precinct of the University of Melbourne.

“The challenge of this project was to get the right tolerance for the wear and tear from moving parts right,” said Ryan. “We designed the mould and then used our in-house 3D printer to make the master moulds so we could be super precise with the castings.”

The project was able to be designed and manufactured in Foote’s Melbourne studio, reducing costs and the probability of human error.

“The challenge of this project is also the highlight, as we got to work with the design at every step to ensure it met the specifications,” said Ryan.

This project took place at the same time Ryan was moving his studio to a much larger site. “The new space was needed as we are taking

on much bigger scale architectural projects in both Australia and internationally.”

The larger space means design and production of projects including large tiled artworks, ceramic door handles and custom light fittings. It also includes a glaze lab where Ryan develops all the glazes they use at the studio from scratch. This allows for new custom finishes or replication of historical glazes on handmade tiles or handles.

As well as production amenities, the new R L Foote Design Studio has a large showroom and gallery, allowing clients to come and see all the glazes and finishes available.

“The studio has capacity for small custom designs as well as much bigger projects,” said Ryan. “We can produce 40 door handles or 10,000 plus tiles, depending on the brief.”

For more information contact R L Foote Design Studio, 1 Parslow Street, Clifton Hill VIC 3068, phone 0404 873 127, website www.rlfootedesign.com



SOIL SAMPLING AND ANALYSIS

Focus Environmental is Australia’s primary environmental and occupational hygiene consultancy and they were responsible for the environmental investigation works for the University of Melbourne Student Precinct project.

“This included investigating, sampling, and analysing the soil and groundwater onsite for any contamination,” said Focus Environmental’s, Dennis Yeoh. “Identified contamination was managed onsite and remediated. This ensures the site is appropriate for its future intended use and proposed development.”

Focus Environmental offers a comprehensive project management solution for the monitoring of hazardous substances and the removal of hazardous materials including final site validations for businesses and organisations nationally.

“As the project included the demolition of multiple buildings, the overall site is extremely big!” said Dennis. “We completed approximately 100 soil samples during the initial environmental investigation. This number has since increased.”

With a wide range of technical and consulting services, risk and liability management are taken to the next level with Focus Environmental’s

systems and processes that protect their clients, projects and the community.

Focus Environmental can provide preliminary site investigations and detailed site investigations, assessment of contaminated soils for offsite disposal, groundwater well installations and monitoring, remediation action plans, environmental management plans and pre-purchase and divestment due diligence assessments.

The team also offers a full suite of NATA accredited asbestos laboratory services. The laboratory team is eager to provide accurate, fast and cost-efficient analysis solutions for your needs. The laboratory team has a combined total of 20 years experience in the laboratory methods for analysing asbestos in materials and air required by Australian OH&S Regulations.

Partnering with some of the biggest names in construction and development, the team at Focus Environmental hold some of the most sought-after skill sets in the country and are often asked for by name to ensure the integrity of sites across the country.

For more information contact Focus Environmental, phone 03 8680 4611, website www.focusenvironmental.com.au

FEATURED FORM AND FUNCTION

Livson Construction Services provided a wide range of architectural metal work on the University of Melbourne Student Precinct project.

This bespoke work includes the balustrade and handrail in the stairway and stairs in the Student Pavilion; cable balustrade in the Atrium; steelwork in the pods for the downstairs food outlets; and a variety of metal work in the Arts and Cultural building including the steel canopy and servery of the coffee pod.



Livson also fabricated and installed the stainless-steel gates and brass handrails in the Frank Tate Building. In the Doug McDonnell Building they undertook the handrail remediation to bring it up to code, along with the stainless steel shelves and link bridge balustrades.

“There was a lot of consultation between us, the architect and the builder to interpret the design intent and bring it to life,” said Livson Construction Services Managing Director, Nathan Spiteri. “Many of the solutions were bespoke in nature and involved quite a bit of detail.” Livson provides an experienced fabrication and installation service to suit all industries. From the biggest construction sites to the smallest fabrication jobs, Livson has a sound reputation for its knowledge and experience in the fabrication industry.

“Our team worked really hard to deliver the Student Precinct project to the standard it is,” said Nathan. “Nothing was standard on this job but we were able to come up with the designs that captured the intent, and were feasible and achievable within the allocated budget and time frames.”

“I’m very proud of the outcome and the effort that produced such a great looking collection of buildings.”

Livson Construction Services is an adaptable business that can operate in any working environment. Experienced in all fabrication, manufacturing, welding and rigging, the construction specialists provide clients with a one-stop-shop for all their construction needs. Livson prides itself on the quality and service provided to its clients.

For more information contact Livson Construction, Unit 3/20 Sunline Drive, Truganina VIC 3029, phone 03 8353 2829, email info@livson.com.au



MASTERS OF JOINERY

A&A Cabinets Impressions Group (AACI Group) is a family owned and operated architectural joinery manufacturer based in Thomastown, Victoria. AACI Group was contracted to provide the wall panelling, theatre wall panelling, banquet seating, balustrade upholstery, fixed tables and feature walls for both the Arts and Cultural Building and the Eastern Resource Centre Library.

“There were multiple challenges to overcome on this project,” said Company Director, Alf Lucchesi. “The complexity of the design and working with the contractors to coordinate the project was a massive part of the challenge. But it was also the highlight.”

AACI Group worked with subcontracted companies including GAAS Upholsters and Decor Panels to supply and install the various elements on this project.

Founded in 1979, AACI Group has built an enviable reputation in the industry for its high quality workmanship, ability to successfully undertake highly detailed and complex projects, with an excellent track record in meeting strict deadlines on all projects undertaken.

AACI Group is committed to building close working relationships with its clients, and offering superior service. The company celebrated 40 years of operation in 2019, and has cemented its name in the industry. AACI Group prides itself on its desire to continually learn and improve as an organisation, and demonstrates this in its highly

automated production process. The company has made significant investment in technology and software systems to achieve this.

From a management perspective, it uses tailored production software to manage client projects and the production process, while from a manufacturing perspective it uses highly sophisticated 3D CAD software to prepare projects for manufacture. The CAD software then directly links to the numerous computer driven CNC machines in its manufacturing plant, enabling a highly efficient operation. This enables the company to offer shorter lead times without sacrificing quality and accuracy.

For more information contact AACI Group, phone 03 9464 2133, email aac@aacabinets.com.au, website www.aacabinets.com.au